



DOUBLE STOREY

TERRACE HOUSES

ONE STAPOK RESIDENCE

CORNER
 Land Area 9.19 PTS onwards
 Build In Area :
 23' X 46.6' / 1986 FT²
 Covered Area : 2878 FT²

INTERMEDIATE
 Land Area 5.36 PTS
 Build In Area :
 23' X 46.6' / 1959 FT²
 Covered Area : 2381 FT²

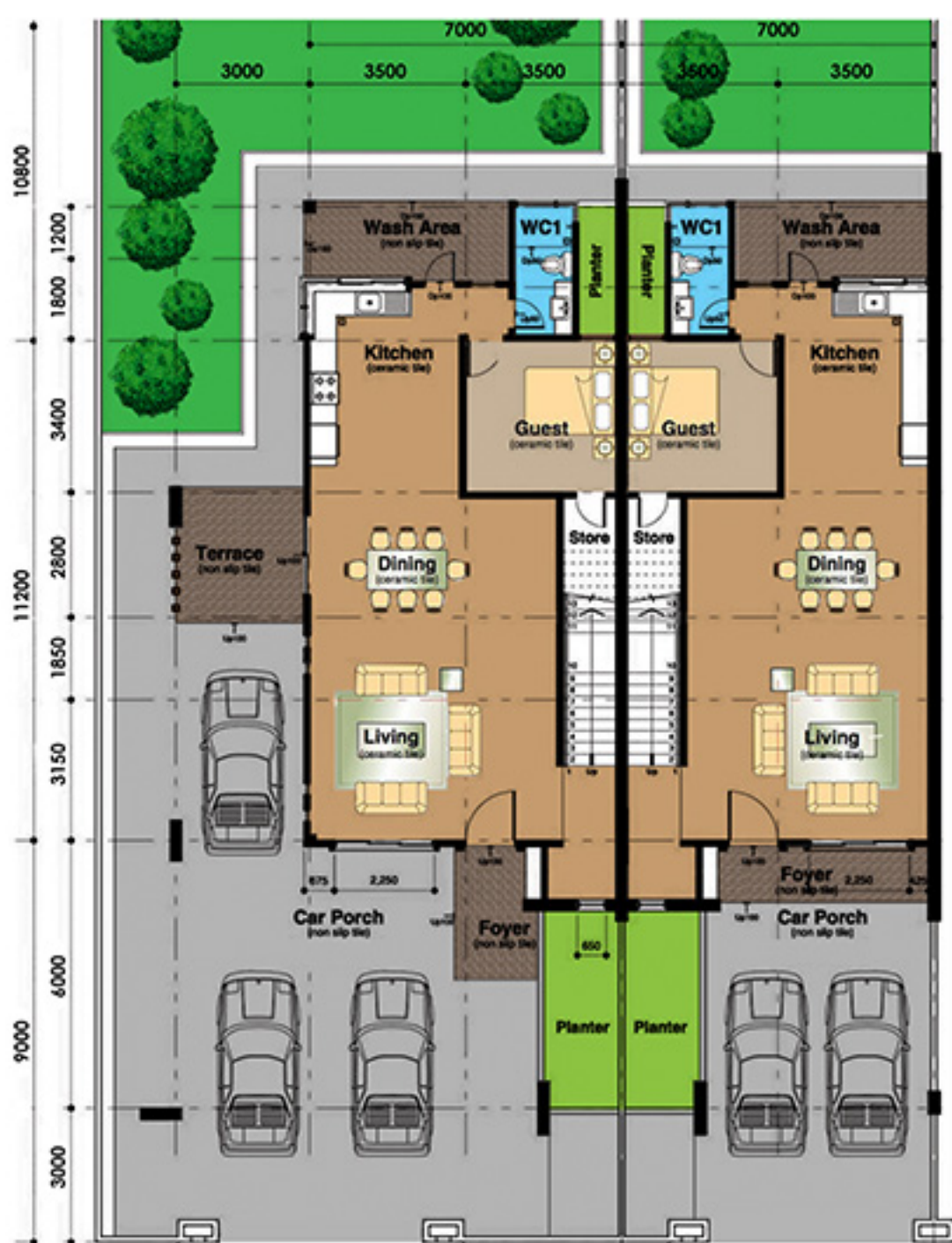

SITE PLAN



- Double Storey Terrace
- Double Storey Semi-Detached

LOCALITY PLAN



TOP GREEN

CONSTRUCTION DEVELOPMENT SDN BHD

1st Floor, Lot 2796-2797,
Block 10, 3rd Mile,
Jalan Tun Ahmad Zaidi Adruce,
93250 Kuching, Sarawak, Malaysia

Tel **082 232 888**

Fax **082 235 288**

Mobile **016 886 9298**

016 886 7829

Office Hour

Monday to Saturday 8am - 5pm



LIVING

All illustrations and colour schemes are artist's impressions only. The information contained herein is subject to change without notification as may be required by the relevant authorities or developer's architect and cannot form part of an offer or contract. All measurements are approximate. Whilst every effort has been made to ensure accuracy, the owner, developer and managers cannot be held responsible for any variations or inaccuracies.

- Developer's License No. : L1811/KP/HD/01/682
- Adv. and Sale Permit No. : P1722/KP/HD/01/682
- Building Plan Ref. No. : 205/11, 206/11, 207/11, 208/11, 209/11
- SPA Approval No. : P/1D/189-06
- Building Plan Approval Authority : Padawan Municipality Council (PMC)
- Member No. : SHEDA/236/02